

# Y-Ball Bearings With Integral Adapter Sleeve

## UH 209/40 2S.T

Y-Ball Bearings With Integral Adapter Sleeve

Harvester

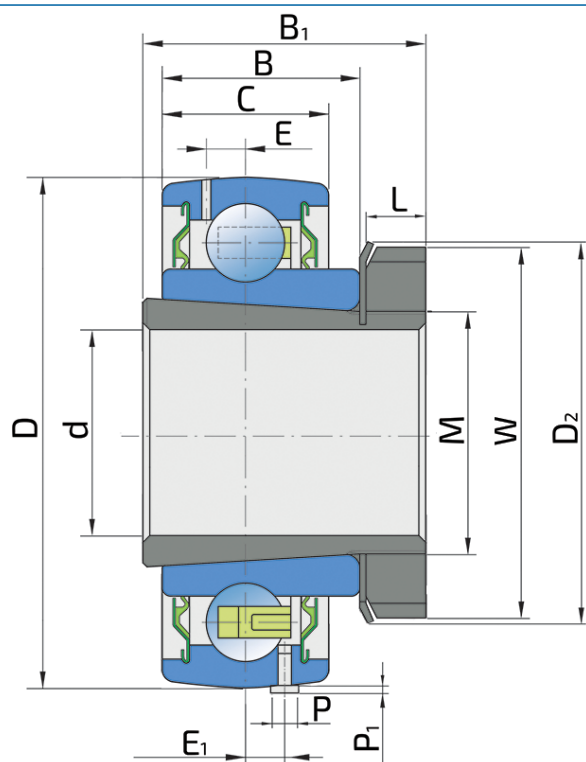

### Technical Specification

d	Bore diameter	40 mm
D	Outside diameter	85 mm
W	KM nut outside diameter	65 mm
D2	MB Washer outside diameter	69 mm
B	Width inner ring	23 mm
B1	Width adapter sleeve	39 mm
C	Width outer ring	21 mm
L	KM nut width	10 mm
E	Distance from raceway centre to the hole for lubrication	6.5 mm
E1	Distance from raceway center to the stopping pin	6.5 mm
M	Thread adapter sleeve	45x1.5 mm
P	Stopping pin diameter	3 mm
P1	Stopping pin high	2 mm
kg	Mass	0.64 kg
Cdyn	Dynamic load rating	33.2 kN
Co	Static load rating	21.6 kN
Pu	Fatigue load limit	0.915 kN

## Sealing

---

### S SEAL / S SEAL (2S)

Single lip seal with the labyrinth between the sheet part and the rubber lip which conducts the contact sealing. The friction and speeds are the same as with RS but provides much better protection against the rough impurity particles. This is very good sealing system: the sheet part protects the seal from the soil, dust and rough particles. At the same time makes the labyrinth with the rubber part. The rubber part provides contact sealing which prevents penetration of finer impurities, water, moisture, steam etc. Suitable for neutral conditions because of the presence of the foreign materials. It is used with the Y bearing (standard) and deep groove ball bearings.

