

Maintenance-Free Bearing With Integrated Flange For Harsh Tillage

IL60-114.5/5T-M30

Maintenance-Free Bearing With Integrated Flange For Harsh Tillage

Disc Harrow

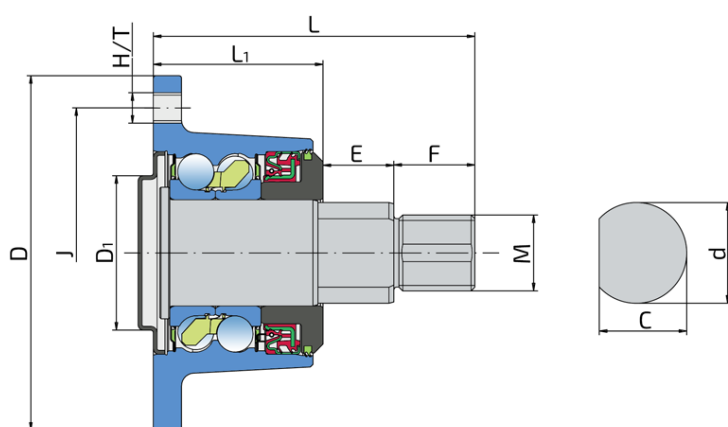

Technical Specification

J	Pitch circle diameter	114.5 mm
D	Outside diameter	140 mm
D1	Center bore on the disc	61 mm
H/T	Hole/Thread	5xM12 mm
d	Bore diameter	39.8 mm
C	D-shape hole cut out dimension	34.5 mm
M	Outer Thread	M30 mm
L	Total length	127 mm
L1	Total flange length	67 mm
E	Length of D shape	28 mm
F	Length of threaded part	32 mm
kg	Mass	3.911 kg
Cdyn	Dynamic load rating	75.86 kN
Co	Static load rating	66.2 kN
Pu	Fatigue load limit	2.78 kN

Sealing

SHEET METAL SHIELD + S SEAL / S SEAL + DIRTBLOCK SEAL + DOUBLE SEAL + FORGED COVER PLATE

Sheet metal shield and S seal on the base side and S seal, Dirtblock seal, Double seal and Forged cover plate on the front side which is exposed to contaminants. Sheet metal shield and S seal together with attached special disc eliminates the possibility of contamination from the base side. Dirtblock seal is designed for hard working conditions at unfriendly environment. Half metal – half rubber outside diameter provides reliable seal retention in the bore and improves sealing performance. Inside diameter is covered by rubber and improves sealing performance and easy installation. Forged cover plate is additional, strong protection of the Dirtblock seal against mechanical damage. Additional double seal protects the bearing from contaminant penetration and ensures a longer service life of the bearing.

