

# The Bearing Solution For Harsh Seeding Conditions And Coulter Discs Of Ploughs, Integrated Flange

## IL35-88/4T-04

The Bearing Solution For Harsh Seeding Conditions And Coulter Discs Of Ploughs, Integrated Flange

Seeding Machines and Manure Handling Machine

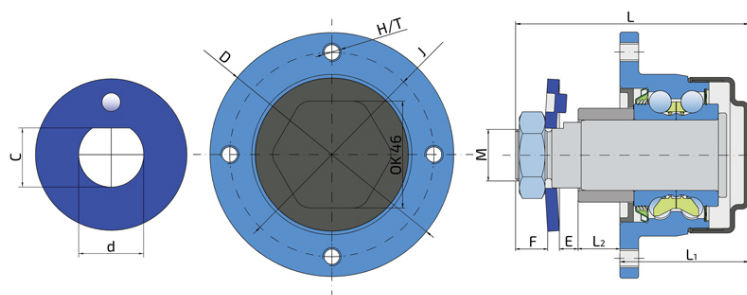

### Technical Specification

J	Pitch circle diameter	88 mm
D	Outside diameter	105 mm
H/T	Hole/Thread	4xM8x1.25 mm
d	Bore diameter	30 mm
C	D-shape hole cut out dimension	24.7 mm
M	Outer Thread	M22x1.5 mm
L	Total length	99.5 mm
L1	Total flange length	55 mm
L2	The distance from the machine carrier to the disc	17,8 mm
E	Length of D shape	8 mm
F	Length of threaded part	13.5 mm
kg	Mass	1.75 kg
Cdyn	Dynamic load rating	37.5 kN
Co	Static load rating	26.5 kN
Pu	Fatigue load limit	1.11 kN

## Sealing

### PLASTIC COVER+T SEAL / RS SEAL+METAL PROTECTIVE CAP

3-lip seal on the base side and the RS seal with metal protective cap on the front side.

The plastic cover on the base side protects the seal from mechanical damage.

3-lip seal on the base side also protected with attached disc, protecting the bearing from contamination.

The RS seal with a Metal protective cap on the front side eliminates bearing contaminants.

&nbsp;

