

# FKL<sup>®</sup>

Made in Serbia

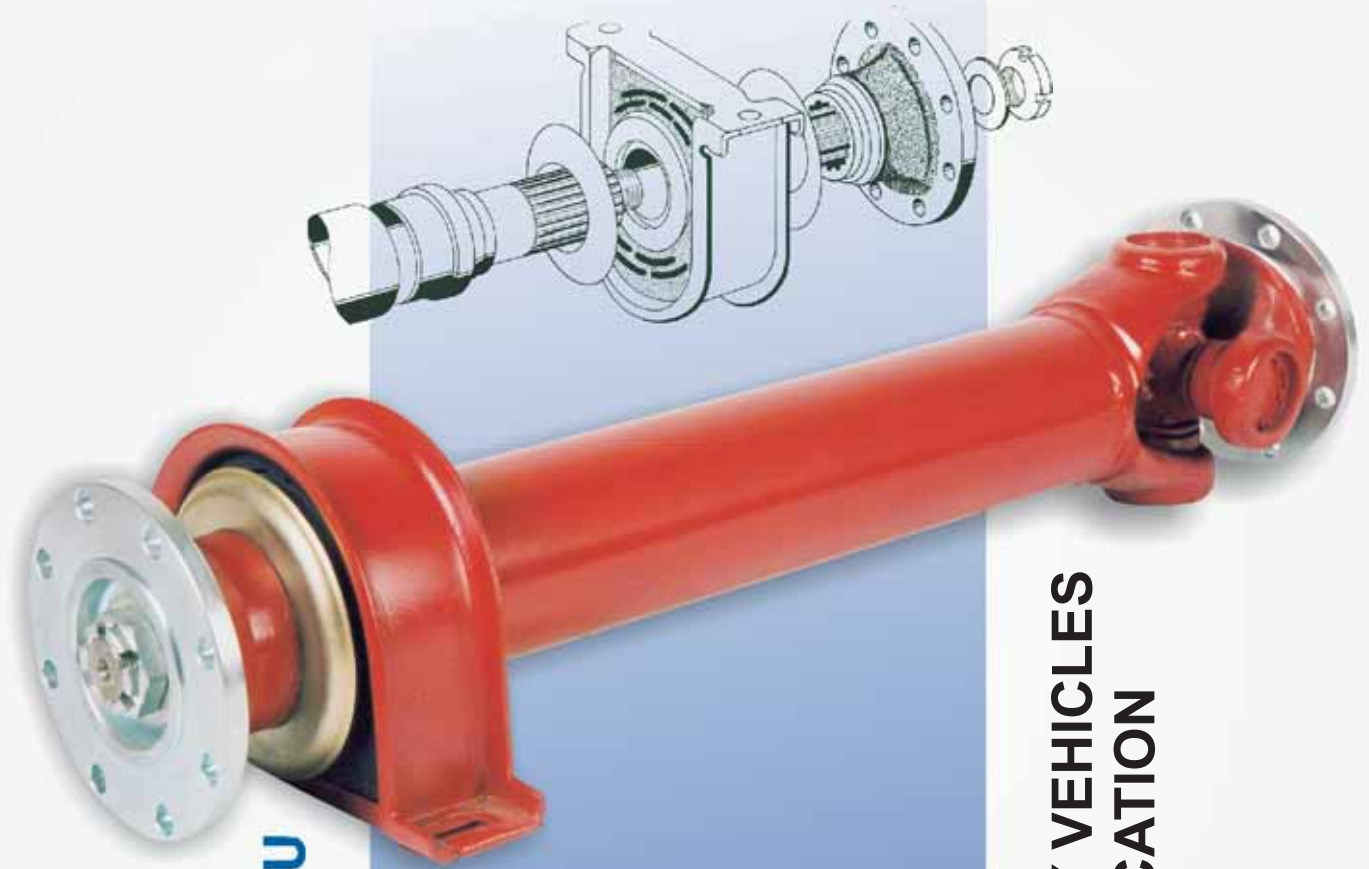

**KARDANSKA VRATILA  
ZA PRIVREDNA VOZILA I INDUSTRIJU**

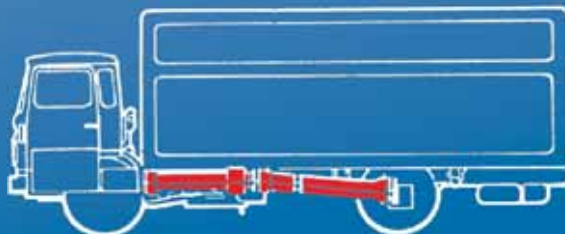
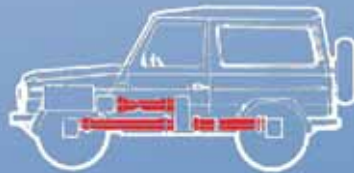

**CARDAN SHAFTS FOR HEAVY VEHICLES  
AND FOR INDUSTRIAL APPLICATION**



[www.fkl-serbia.com](http://www.fkl-serbia.com)



**KARDANSKA VRATILA  
CARDAN SHAFTS**

**CEVNA IZVEDBA:  
TUBULAR DESIGN: A.01**

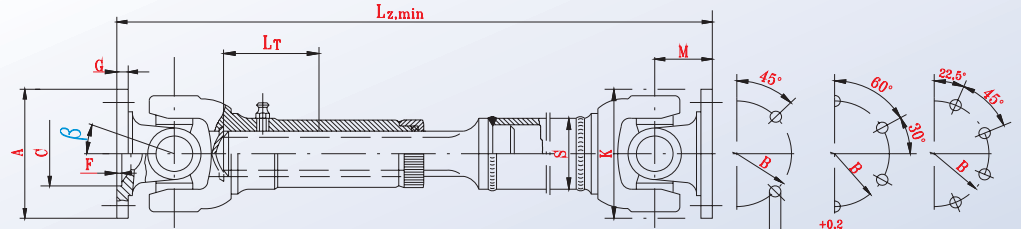

**CEVNA IZVEDBA:  
TUBULAR DESIGN: B.01**

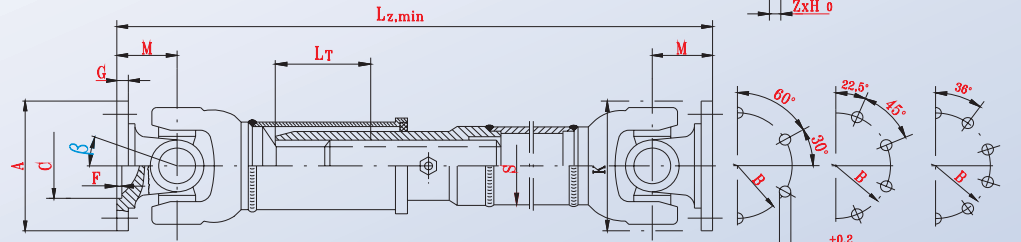

**CEVNA IZVEDBA:  
TUBULAR DESIGN: C.01**

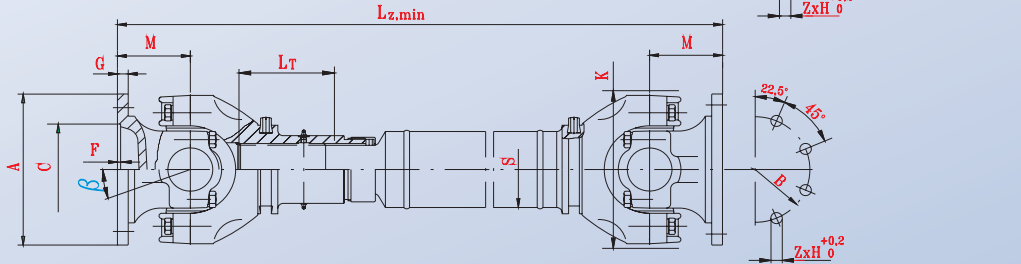

**IZVEDBA SA DUGAČKIM  
TELESKOPIRANJEM:  
DESIGN:  
WITH LARGE LENGHT  
COMPENSATION**

**.02**

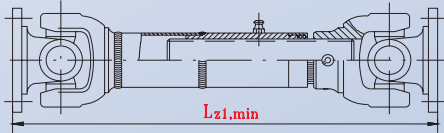

**KRATKA IZVEDBA:  
SHORT DESIGN: .14**

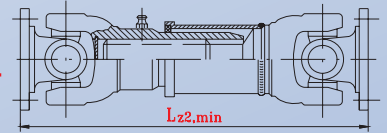

**IZVEDBA BEZ  
TELESKOPIRANJA:  
DESIGN:  
WITHOUT LENGHT  
COMPENSATION**

**.03**

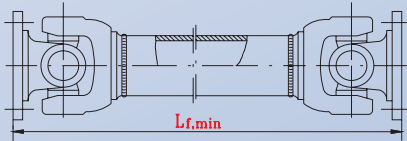

**DVOSTRUKI  
ZGLOB:  
DOUBLE  
JOINT: .05**

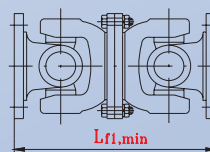

**JEDNOSTR.  
ZGLOB:  
SINGLE  
JOINT: .07**

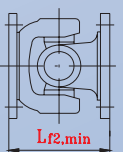

**SKLOPOVI KRSTAKA  
JOURNAL CROSS  
ASSEMBLIES**

**ZA IZVEDBE:  
FOR DESIGN: A, B**

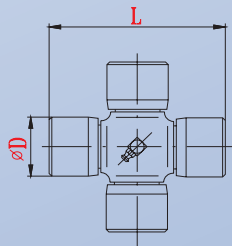

**ZA IZVEDBE:  
FOR DESIGN: C**

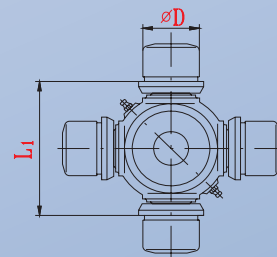

**ALTERNATIVNE PRIRUBNICE KARDANA  
OTHER POSSIBLE FLANGE FITTINGS**

**“DIN”**

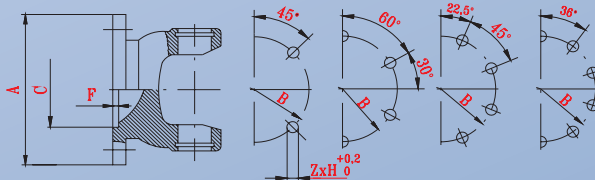

**“SAE”**

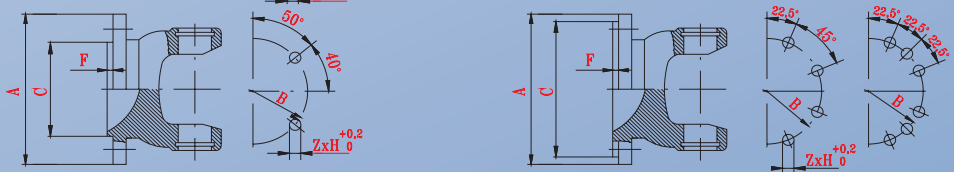

**KV-PRIRUBNE VILE  
PREMA-ISO 12667**

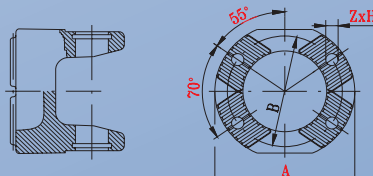

**XS-CROSS SERRATION  
FLANGE YOKES-ISO 12667**

VELIČINA/SIZE		65	75	90	100	120	150	165	180	180W	225	250	285*	
Md	Nm	225	400	1250	2000	3400	6200	10000	12000	15000	18000	22000	28000	
IZVEDBA/DESIGN		A	A	A,B	A,B	A,B	B	A,B	B	B	B	C	C	
DIMENZIJE/DIMENSION	β	°	24	24	24	24	24	30	24	35	30	24	15	15
	∅A	mm	65	75	90	100	120	150	165	180	180	225	250	285
	B	mm	52	62	74,5	84	101,5	130	140	155,5	155,5	196	218	245
	∅C	mm	35	42	47	57	75	90	95	110	110	140	140	175
	F	mm	1,7	2	2,5	2,5	2,5	3	3	3	3,5	5	6	7
	G	mm	4,5	5,5	6	7	8	10	12	12	14	15	18	20
	M	mm	32	42	48	48	60	75	96	100	100	108	130	135
	ZxH	mm	4x6,1 4x8,1 8x6,1	4x6,1 6x6,1 8x6,1	4x8,1 6x8,1	4x10,1 6x8,1 8x8,1	8x8,1 8x10,1	8x10,1 8x12,1	8x16,1	8x14,1 8x16,1 10x16,1	10x16,1	8x16,1 8x18,1	8x18,1	8x20,1
	∅K	mm	60	68	97	97	125	146	160	173	178	250	250	285
	L <sub>T</sub>	mm	35	35	40	40	60/100	110	100	110	110	110	80	100
	∅S	mm	42	42	60	60	70	85	100	100	120	114	146	146
	L <sub>z,min</sub>	mm	280	325	370	370	430	565	640	695	790	715	855	960
	L <sub>z1,min</sub>	mm	510	525	600	600	600	870	910	1000	1100	1020	1110	1200
	L <sub>z2,min</sub>	mm	180	220	250	250	315	350	460	520	600	530	730	760
	L <sub>f,min</sub>	mm	188	220	220	220	280	370	370	440	450	480	620	700
	L <sub>f1,min</sub>	mm	128	168	192	192	240	300	320	400	400	432	520	540
	L <sub>f2,min</sub>	mm	64	84	96	96	120	150	160	200	200	216	260	270
	∅K	mm	20	22	27	32	38	48	56	57	57	65	74	83
	L	mm	47,2	55,2	79,1	82	105,8	121,8	133	144	152	172,4		
	L <sub>1</sub>	mm											154	175
	"DIN"													
	∅A	mm	58		100	90	150	165	150	165				315
	B	mm	47		84	74,5	130	140	130	140				285
	∅C	mm	30		57	47	90	95	90	95				175
	F	mm	1,5		2,5	2,5	3	3	3	3				7
	ZxH	mm	4x5,1		6x8,1	4x8,1	8x12,1	8x16,1	8x12,1	8x16,1				8x22,1
	∅A	mm							180					
B	mm							155,5						
∅C	mm							110						
F	mm							3						
ZxH	mm							8x12,1						
"SAE"	mm													
∅A	mm			97	116	120	150	175	205		230			
B	mm			79,37	95,25	95,25	120,65	155,5	184,15		205			
∅C	mm			60,32	69,85	69,85	95,25	168,23	196,81		223			
F	mm			1,5	1,4	1,5	1,5	3	3		3,8			
ZxH	mm			4x10,1	4x12,1	4x11,1	4x14,1	8x10,1	12x10,1		8x12,1			
ISO 12667														
∅A	mm						150	150		180				
B	mm						130	130		150				
ZxH	mm						4x13	4x13		4x15				

## MEĐUVRATILA INTERMEDIATE SHAFTS

IZVEDBA:  
DESIGN: .10

“ZASTAVA - IVECO”  
“TAM”

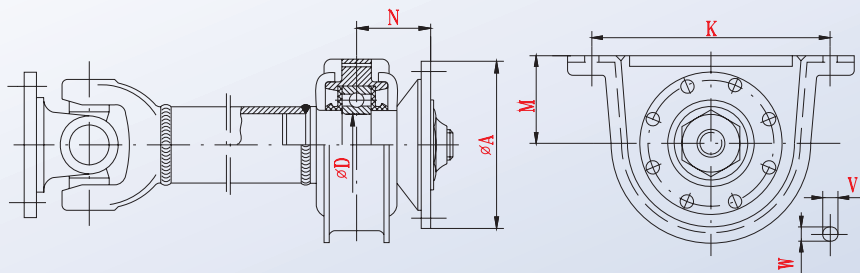

$\varnothing D$	$\varnothing A$	N	M	K	V	W
mm	mm	mm	mm	mm	mm	mm
35	116	78	58	168	14,2	13
40	120	85	62,7	168	14,2	13
45	150	75,8	69,1	194	14,2	13
55	150	95	71,5	194	15	30
60	180	100	80	200	15	30

IZVEDBA:  
DESIGN: .20

“TAM 75”

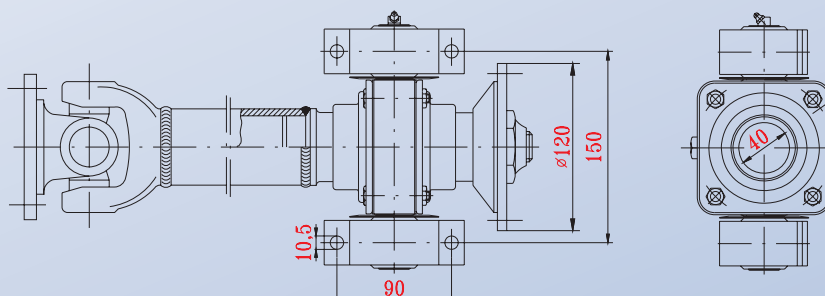

IZVEDBA:  
DESIGN: .20

“FAP”

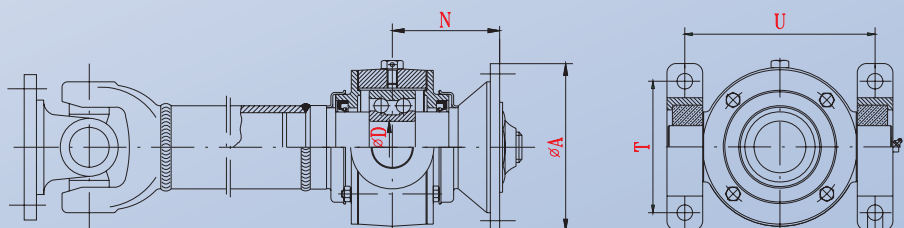

$\varnothing D$	$\varnothing A$	N	T	U	V
mm	mm	mm	mm	mm	mm
50	150	120	140	180	14,5
65	150	128	140	214	14,5

IZVEDBA:  
DESIGN: .25

“FAP”

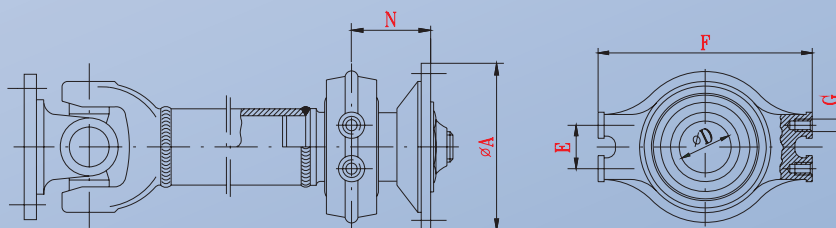

$\varnothing D$	$\varnothing A$	N	F	E	G
mm	mm	mm	mm	mm	mm
55	150	88,5	190	50	M12
60	150	94,5	247	50	M12
	165 180	110			

IZVEDBA:  
DESIGN: .40

“MB”

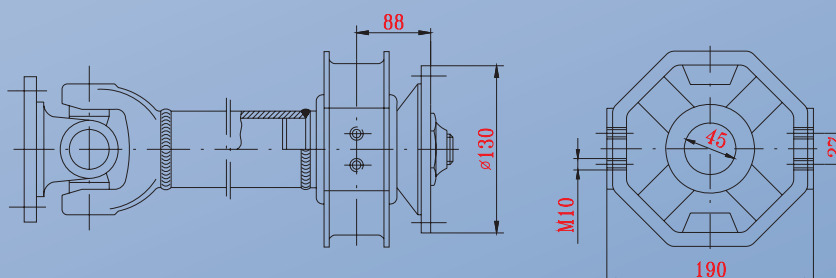

**ZGLOBNE POLUOSOVINE**  
**DOUBLE JOINT SHAFTS**

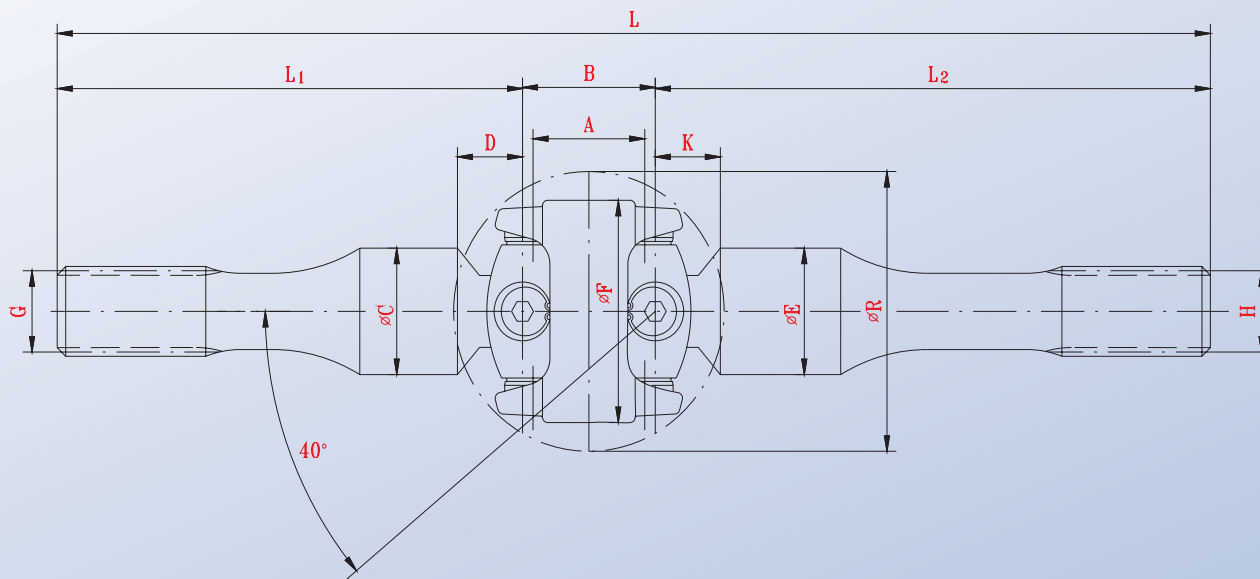

Tip	Md	A	B	øC	D	øE	øF	K	øR	G	H	L <sub>1</sub>	L <sub>2</sub>	L
Type	Nm	mm	mm	mm	mm	mm	mm	mm	mm	mm	mm	mm	mm	mm
P5-5	6500	62	80	45	34	50	138	37	193	40x44 DIN 5481	40x44 DIN 5481	251	731	1062
P5-5	6500	62	80	50	32	50	138	43	193	48x1,25x37 DIN 5480	48x1,25x37 DIN 5480	254	731	1065

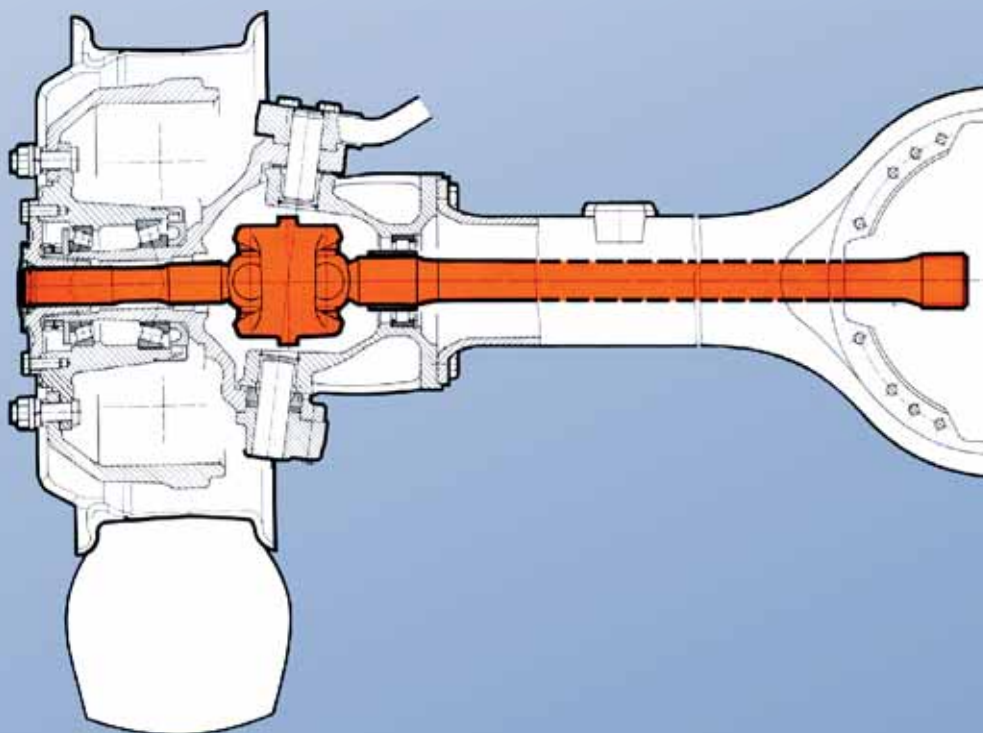

FACTORY OF ROLLER BEARINGS AND CARDAN SHAFTS

# FKL®

FABRIKA KOTRLJAJUĆIH LEŽAJEVA I KARDANA

Industrijska zona bb

21235 TEMERIN

SRBIJA

Tel.: +381 21 6841 100, Fax: +381 21 842 650

E-mail: marketing@fkl-serbia.com

Industrijska zona bb

21235 TEMERIN

SRBIJA

Phone: +381 21 6841 100, Fax: +381 21 842 650

E-mail: marketing@fkl-serbia.com



CILINDRIČNO VALJKASTI LEŽAJI

CILYNDRICAL ROLLER BEARINGS

RADIJALNI KUGLIČNI LEŽAJI

DEEP GROVE BALL BEARINGS

PODESIVI LEŽAJI I LEŽAJNE JEDINICE (Y PROGRAM)

Y INSERT BEARINGS AND BEARINGS UNITS

KARDANSKA VRATILA ZA MOTORNA VOZILA

CARDAN SHAFTS FOR MOTORS VEHICLES

KARDANSKA VRATILA ZA POLJOPRIVREDU

CARDAN SHAFT FOR AGRICULTURE

SPOJNICE ZA KARDANSKA VRATILA

OVERLOAD AND OVERRUNNING CLUTCHES

KARDANSKA VRATILA ZA INDUSTRIJU

CARDAN SHAFTS FOR INDUSTRY

DVOREDNI BURIČASTI LEŽAJI

DOUBLE ROW SPHERICAL ROLLER BEARINGS

IGLICASTI LEŽAJI I LEŽAJI ZA POLJOPRIVREDNU MEHANIZACIJU

NEEDLE ROLLER BEARINGS AND BALL BEARINGS FOR AGRICULTURAL MACHINES

ZGLOBNI LEŽAJI

PLAIN BEARINGS

LEŽAJI KVAČILA

CLUTCH BEARINGS

**BRANCH OFFICES:**

**TEMKO SKOPJE**

Socijalistička zora 39  
91060 SKOPJE

**MACEDONIA**

Phone/Fax: +389 23 66 068

**LLC "FKL-RUSSIA"**

Novgorodskaya Str. 121

394088 VORONEZH

**RUSSIAN FEDERATION**

Phone/Fax: +74732 747150 / 748361

E-mail: mail@rusfkl.ru

**PREDSTAVNIŠTVA:**

**BEOGRAD**

Birčaninova 30,  
11000 BEOGRAD  
Tel./Fax: 011/361-0833  
Tel.: 011/3610-260, Fax: 011/3610-592  
E-mail: ffkllbg@eunet.rs

**KRUŠEVAC**

Tel./Fax: 037/692-550  
Mob.: 064/173-96-45  
063/537-807  
E-mail: sasafkl@ptt.rs

**NIŠ**

Dr Dragiše Mišovića 12  
18000 Niš  
Tel.: 018/212-467  
Fax: 018/212-672; 212-478

**PRODAJNI CENTAR TEMERIN**

Novosadska 535,  
21235 TEMERIN  
Tel./Fax: 021/841-900, 841-901